

D. D. A. DWARKA PROJECT

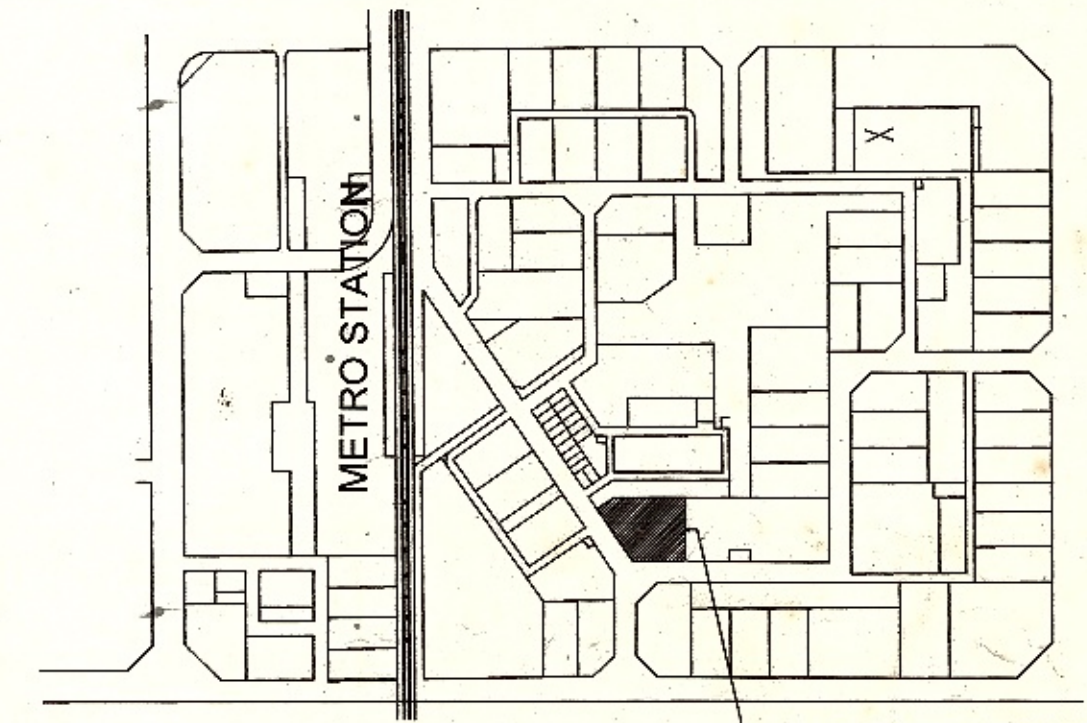

KEY PLAN

PROPOSED SITE

AREA STATEMENT :-

USES	AREA(SQ.M.)
TOTAL AREA OF POCKET	: 8140.00 SQ.M
MULTIPURPOSE COMM. HALL	: 1994.30
HOTEL	: 1525.75
CSC- I(Including M.B. & V.B.)	: 1476.24
DISPENSARY	: 832.00
RELIGIOUS BUILDING	: 400.50
CIRCULATION/ PARKING	: 1911.21
TOTAL	8140.00 SQ.M.

NOTE :

THIS DRG. HASE BEEN PREPARED ON THE BASIS OF P.T SURVEY OF COMMERCIAL LAND AT SECTOR-10,VIDE SURVEY DRG. NO. 035 DATED 07.02.07

WRITTEN DIMENSIONS ONLY TO BE FOLLOWED
Ref. File F4(10)08/Plg./Dwk./Pt. IV

LAYOUT PLAN OF H.A.F. POCKET-'A',
SECTOR 10,DWARKA.

DWK/Sec10/HAF/Pt. IV/08/59

SCALE :

DRG. NO.

B.N. SHARMA
PLG. D/ MAN

MANJIT SHARMA
PLG. ASSTT.

DATE

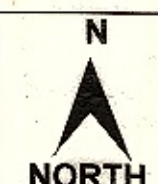

DURGA NAND MINZ
ASSTT. DIR. (PLG.)

TAPAN MONDAL
JT. DIRECTOR (PLG.)

S.P. PATHAK
DIRECTOR (PLG.)

DELHI DEVELOPMENT AUTHORITY

PLOTTED DEVELOPMENT

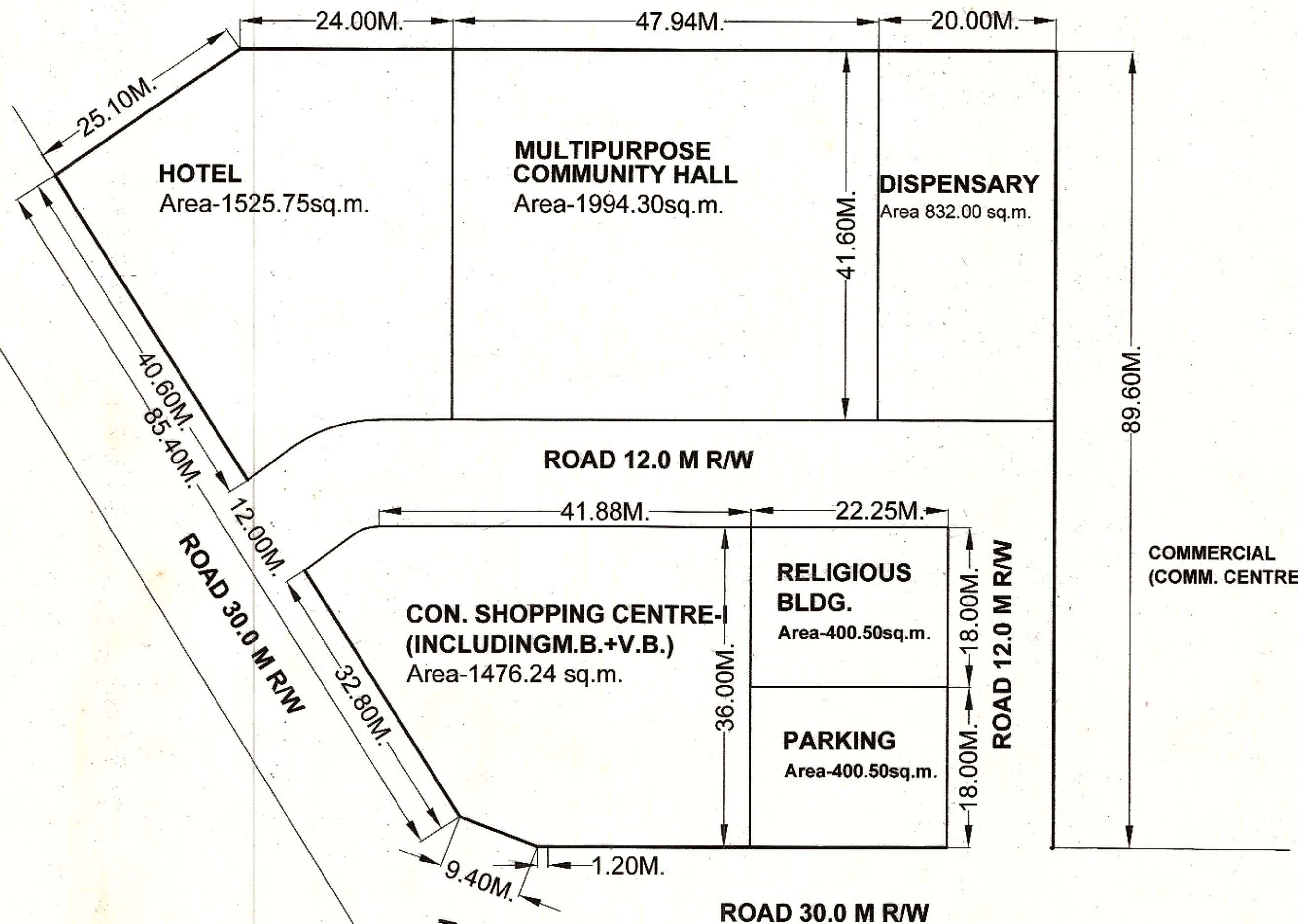

GOVT. LAND

COMMERCIAL
(COMM. CENTRE)

C.G.H.S.

The scheme was discussed in the 272 nd Screening Committee meeting held on 08.12.2008 vide item no. 178:2008.
The proposal as reflected in the agenda was approved subject to :
* The Banquet hall be converted to Hotel.
* Religious site II towards 30 M wide road be omitted and converted to parking.